

Sealed Series:

Radial Contact Series

(C Type)

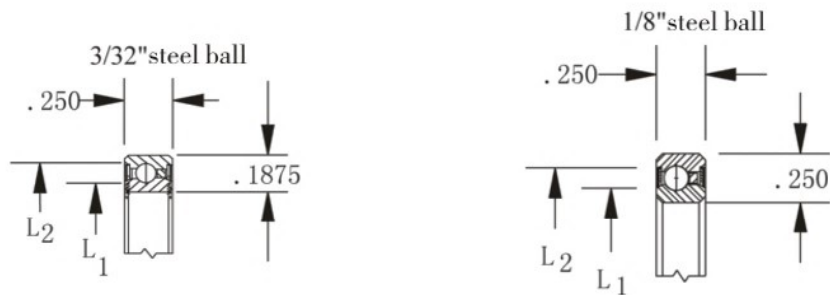

HJHA series							Weight(kg)
Type	Dimension(inch/mm)				Basic Load Ratings(N)		
	d	D	L1	L2	Cor	Cr	
HJHA010C	1.000	1.375	1.108	1.274	1290	670	0.016
	25.4	34.925	28.1	32.4			
HJHA015C	1.500	1.875	1.608	1.771	1780	800	0.024
	38.1	47.625	40.8	45.1			

HJA series							Weight(kg)
Type	Dimension(inch/mm)				Basic Load Ratings(N)		
	d	D	L1	L2	Cor	Cr	
HJA020C	2	2.5	2.148	2.356	3020	1420	0.045
	50.8	63.5	54.6	59.8			
HJA025C	2.5	3	2.648	2.856	3690	1600	0.054
	63.5	76.2	62.7	72.5			
HJA030C	3	3.5	3.148	3.356	4400	1820	0.064
	76.2	88.9	80	85.2			
HJA035C	3.5	4	3.648	3.856	5070	2000	0.077
	88.9	101.6	92.7	98			
HJA040C	4	4.5	4.148	4.356	5730	2130	0.086
	101.6	114.3	105.4	110.6			
HJA042C	4.25	4.75	4.398	4.606	6090	2220	0.091
	107.95	120.65	111.7	117			
HJA045C	4.5	5	4.684	4.856	6400	2310	0.095
	114.3	127	118	123.3			
HJA047C	4.75	5.25	4.898	5.106	6760	2400	0.1
	120.65	133.35	124.4	129.7			
HJA050C	5	5.5	5.148	5.356	7070	2490	0.104
	127	139.7	130.8	136			
HJA055C	5.500	6.000	5.648	5.856	7780	2620	0.113
	139.7	152.4	143.5	148.7			
HJA060C	6.000	6.500	6.148	6.356	8450	2800	0.127
	152.4	165.1	156.2	161.4			
HJA065C	6.500	7.000	6.648	6.856	9110	2930	0.136
	165.1	177.8	168.9	174.1			

5/32" steel ball

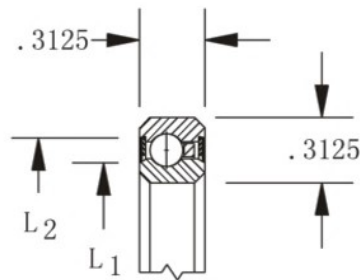

HJB series							Weight(kg)
Type	Dimension(inch/mm)				Basic Load Ratings(N)		
	d	D	L1	L2	Cor	Cr	
HJB020C	2	2.625	2.136	2.362	4130	2000	0.068
	50.8	66.7	54.3	60			
HJB025C	2.5	3.125	2.636	2.862	5070	2310	0.086
	63.5	79.375	67	72.7			
HJB030C	3	3.625	3.136	3.362	5960	2580	0.1
	76.2	92.075	79.7	85.4			
HJB035C	3.5	4.125	3.636	3.862	6850	2800	0.122
	88.9	104.775	92.4	98.1			
HJB040C	4	4.625	4.136	4.362	7780	3070	0.136
	101.6	117.475	105	110.8			
HJB042C	4.25	4.875	4.386	4.662	8130	3160	0.141
	107.95	123.825	111.4	118.4			
HJB045C	4.5	5.125	4.636	4.862	8670	3290	0.154
	114.3	130.175	117.8	123.5			
HJB047C	4.75	5.375	4.886	5.162	9020	3380	0.159
	120.65	136.525	124.1	131.1			
HJB050C	5	5.625	5.136	5.362	9560	3510	0.168
	127	142.875	130.5	136.2			
HJB055C	5.5	6.125	5.636	5.862	10490	3730	0.181
	139.7	155.575	143.2	148.9			
HJB060C	6	6.625	6.136	6.362	11380	3960	0.2
	152.4	168.275	155.9	161.6			
HJB065C	6.5	7.125	6.638	6.862	12270	4130	0.213
	165.1	180.975	168.6	174.3			

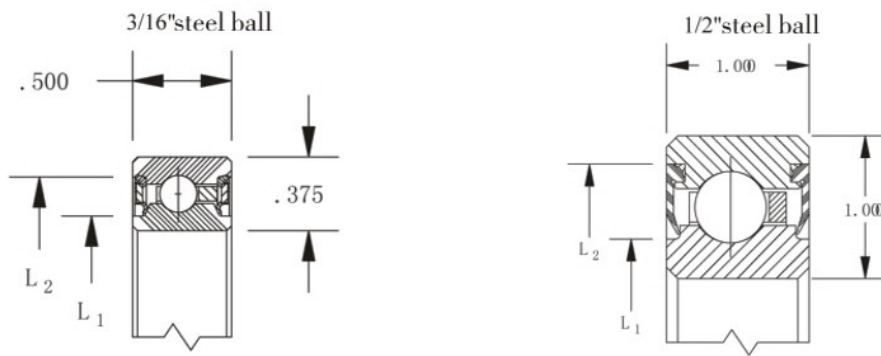

HJU series							Weight(kg)
Type	Dimension(inch/mm)				Basic Load Ratings(N)		
	d	D	L1	L2	Cor	Cr	
HJU040C	4	4.75	4.15	4.547	9340	3910	0.249
	101.6	120.65	105.4	115.5			
HJU042C	4.25	5	4.4	4.797	9870	4090	0.263
	107.95	127	111.76	121.8			
HJU045C	4.5	5.25	4.65	5.047	10400	4220	0.277
	114.3	133.35	118.1	128.2			
HJU047C	4.75	5.5	4.9	5.295	10940	4360	0.295
	120.65	139.7	124.5	134.5			
HJU050C	5	5.75	5.15	5.545	11510	4490	0.308
	127	146.05	130.8	140.8			
HJU055C	5.5	6.25	5.56	6.042	12580	4800	0.336
	139.7	158.75	143.5	153.5			
HJU060C	6	6.75	6.15	6.542	13650	5070	0.367
	152.4	171.45	156.2	166.2			
HJU065C	6.5	7.25	6.65	7.037	14710	5330	0.395
	165.1	184.15	168.9	178.7			
HJU070C	7	7.75	7.15	7.537	15780	5560	0.422
	177.8	196.85	181.6	191.4			
HJU075C	7.5	8.25	7.65	8.037	16850	5820	0.449
	190.5	209.55	194.3	204.1			
HJU080C	8	8.75	8.15	8.537	17910	6050	0.481
	203.2	222.25	207	216.8			
HJU090C	9	9.75	9.15	9.535	20050	6530	0.535
	228.6	247.65	232.4	242.2			
HJU100C	10	10.75	10.15	10.535	22180	6980	0.594
	254	273.05	257.8	267.6			
HJU110C	11	11.75	11.15	11.535	24310	7420	0.649
	279.4	298.45	283.2	293			
HJU120C	12	12.75	12.15	12.535	26450	7870	0.708
	304.8	323.85	308.6	318.4			

HJG series							Weight(kg)
Type	Dimension(inch/mm)				Basic Load Ratings(N)		
	d	D	L1	L2	Cor	Cr	
HJG120C	12	14	12.554	13.602	94860	37830	4.218
	304.8	355.6	318.9	345.5			
HJG140C	14	16	14.554	15.602	109440	41610	4.899
	355.6	406.4	369.7	396.3			
HJG160C	16	18	16.554	17.602	124060	45250	5.579
	406.4	457.2	420.5	447.1			
HJG180C	18	20	18.554	19.602	138640	48720	6.214
	457.2	508	471.3	497.9			
HJG200C	20	22	20.554	21.602	153220	52100	7.167
	508	558.8	522.1	548.7			